

Diaphragm chemical seals D1xx-D2xx-D3xx-D120/D121

A wide choice of configurations to suit customer requirements:

D300 to D314: 0 + 0.16 to 0 + 25 bar and -1 + 0 to -1 + 24 bar

D200 to D214: 0 + 1 to 0 + 40 bar and -1 + 3 to -1 + 24 bar

D100 to D114: 0 + 4 to 0 + 160 bar and -1 + 9 to -1 + 24 bar

D120 - D121: 0 + 160 to 0 + 1000 bar

These series are designed for gauge pressure measurement from 0.16 to 1000 bar of corrosive fluids within temperature ranges between -60° and +200°C.

If the pressure indicator or transmitter are damaged, the chemical seal diaphragm keeps the system sealed.

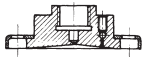

Chemical seal definition table

	Measurement ranges in bar	0 + 0,16 to 0 + 25 -1 + 0 to -1 + 24 0 + 24 bar absolute	0 + 1 to 0 + 40-1 + 3 to -1 + 24	0 + 4 to 0 + 160 -1 + 9 to -1 + 24	0 + 160 0 + 1000
DX00 and D120 (X = 1 or 2 or 3)	Type of assembly	TOP HOUSING WITH FEMALE THREAD FLUSH DIAPHRAGM			
	Top housing with welded diaphragm	D300	D200 D207 ⁽²⁾	D100 D107 ⁽¹⁾	D120

M = Male process connection / F = Female process connection

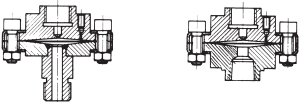
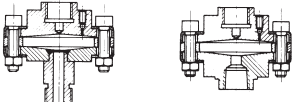
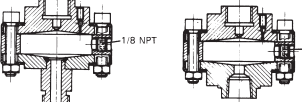
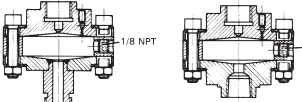
DX01to DX04 and D121 (X = 1 or 2 or 3)	Type of assembly	TOP HOUSING WITH FEMALE THREAD SCREW-TYPE PROCESS CONNECTION						
		M	F	M	F	M	F	F
	Standard chemical seal with welded diaphragm	D301	D311	D201 D208 ⁽²⁾	D211 D218 ⁽²⁾	D101 D108 ⁽¹⁾	D111 D118 ⁽¹⁾	D121
	Standard chemical seal with clamped diaphragm and clamping ring	D302	D312	D202	D212	D102	D112	-
	Chemical seal with cleaning ring and clamped diaphragm	D303	D313	D203	D213	D103	D113	-
	Chemical seal with cleaning ring and welded diaphragm	D304	D314	D204 D209 ⁽²⁾	D214 D219 ⁽²⁾	D104 D109 ⁽¹⁾	D114 D119 ⁽¹⁾	-

⁽¹⁾ Reinforced version: P max up to 400 bar

⁽²⁾ Reinforced version: P max up to 100 bar

Measurement ranges Chemical seal mounted on DN 100 pressure gauge
 Fluid temperature: -20°C ≤ T ≤ 100°C
 Ambient temperature: -10°C ≤ T ≤ 50°C

For other service conditions, see our «Chemical Seal Technical Guide»

Dimensions

Weights given for G1/2 stainless steel models

Series DX01 to DX04

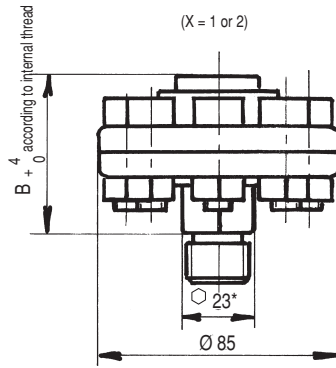

Type	B	Weight kg D101 to D104	Weight kg D201 to D204
D101/201	54	0.965	0.935
D102/202	62	1.215	1.135
D103/203	69	1.425	1.320
D104/204	69	1.425	1.320

* Ø 22 for monel version

Series DX11 to DX14 and D121

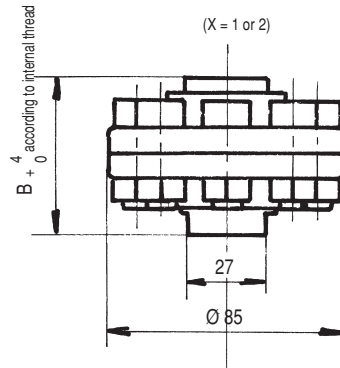

Type	B	Weight kg D111 to D114	Weight kg D211 to D214	Weight kg D121
D111/211	54	0.975	0.995	-
D112/212	62	1.225	1.195	-
D113/213	69	1.435	1.380	-
D114/214	69	1.435	1.380	-
D121	54			1.410

Series D301 to D304

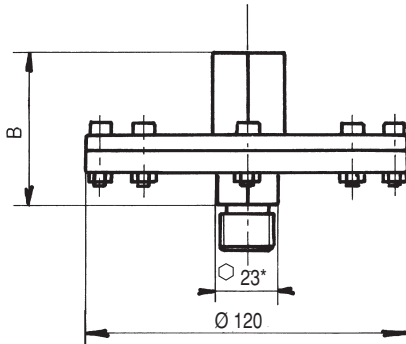

Type	B	Weight kg
D301	59	1.340
D302	65	1.535
D303	73	1.810
D304	73	1.810

* Ø 22 for monel version

Series D311 to D314

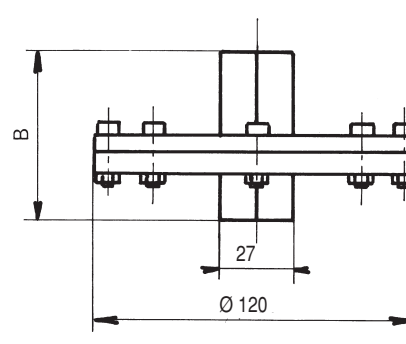

Type	B	Weight kg
D311	65	1.390
D312	71	1.585
D313	79	1.850
D314	79	1.850

Flange machining for D100-D200-D300-D120 mounting

D100 - D200 - D120

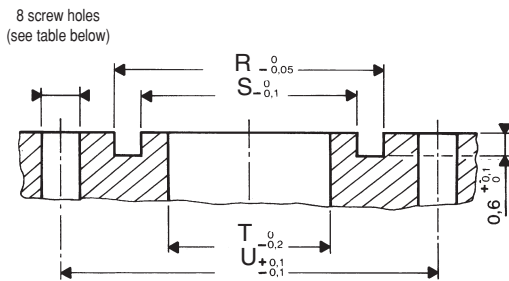

	D100	D200	D120
R	50.1	59.1	40.1
S	46	55	36
T	45	54	35
U	65	70	65
Screw	M10	M8	M10

D300

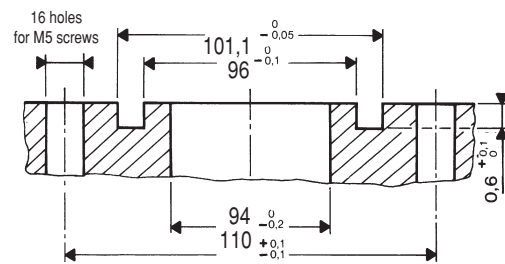

Sealing gasket		
Type	Material	Dimensions
D1xx	PTFE	Ø49.8 x Ø45.8 x 1
D120/D121	stainless steel 1.4404	Ø40 x Ø36 x 1
D2xx	PTFE	Ø58.8 x Ø54.8 x 1
D3xx	PTFE	Ø101 x Ø97 x 1